



Adam Tas Corridor Energy

A distribution box has several wire connections





Overview

Inside the box, you'll find things like circuit breakers, busbars, terminal blocks, and wires. Some boxes also include DIN rails for mounting extra devices and cable entry points to keep wires neat. A distribution box, also known as a distribution board, electrical panel, or breaker box, is an enclosure that houses electrical components responsible for distributing electricity throughout a building. Safety: Ensure that all wiring complies with safety regulations to avoid safety hazards such as short circuit, overload and electric shock.



A distribution box has several wire connections

How To Connect A Distribution Box

Learn how to connect a distribution box with this easy-to-follow, step-by-step guide. From tools and materials needed to common installation mistakes and solutions, this comprehensive article will



A Step-by-Step Guide to Wiring an Electrical Panel Box

Find out how to properly wire an electrical panel box with a comprehensive diagram and step-by-step instructions.



Distribution box Wiring Connection Diagram , Animated Guide , DB Box

The basics of home electrical distribution systems Key components of a wiring diagram How to safely and efficiently connect circuits Step-by-step animated instructions Whether you're a DIY

Distribution Box Wiring Principles

?Functionality?: The wiring diagram should clearly reflect the functional requirements of the Distribution box, including the correct connection



What is an Electrical Distribution Box? A

Keeps Power Organized: Instead of a messy web of wires running through the walls, all power connections lead back to the distribution box. This

The installation requirements for the distribution box

Learn how to install a distribution box safely and correctly. Covers wiring, placement, standards, and expert tips for a compliant setup.



Distribution box Wiring Connection Diagram , Animated Guide , DB

Welcome to our comprehensive animated guide on home distribution wiring connection diagrams! In this video, we'll walk you through the essentials of wiring your home for electricity, ensuring



Distribution Box and Selection Guide

Distribution Box Selection Guide This guide provides information on how to select the appropriate Distribution Box for Electric project. If you have any



Size determination, installation method and wiring mode

The distribution box is the central hub of the home circuit and the general control of our daily power consumption. It is an indispensable electrical equipment. If there

Understanding Distribution Boxes: Your Guide to Power

A: A junction box is primarily used to connect electrical wires, while a distribution box is designed to distribute power to various circuits. The distribution



What is a Distribution Box? - A Comprehensive Guide

A distribution box organizes and controls power flow, ensuring safety and efficiency in electrical systems.



Understanding Circuit Breaker Wiring Configurations in

Correct wiring methods for circuit breakers within distribution boxes are fundamental to ensuring electrical safety and compliance with established codes.



Complete Guide For Distribution Boxes Types

Organization: By consolidating multiple electrical connections in a single enclosure, distribution boxes help keep wiring organized and manageable. This organization

How to Wire a Home Distribution Box

How to Wire a Home Distribution Box - Step-by-Step , Distribution DB box wiring diagram
Welcome to our channel! In this video, we'll walk you through the





How to Wire a Home Distribution Box

The above mentioned electrical wiring accessories and protective devices are used to control and distribute electric supply (safely to connected

The Complete Guide to Distribution Box: Installation, Types & More

What's the difference between a distribution box and a sub-panel? A distribution box typically refers to the main electrical panel that receives power from the utility service. A sub-panel is

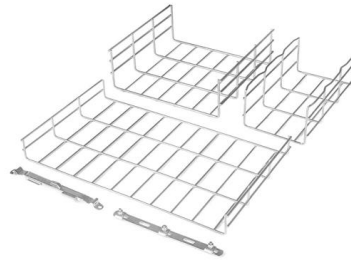

What Is an Electrical Distribution Box? A Complete Guide

Wiring connections that facilitate organized and efficient power distribution to various circuits. Grounding methods aimed at

How to Choose a House Distribution Box , CHINT global

A well-chosen distribution box ensures the safety and efficiency of your household electrical system. This article guides you through selecting a



Step-by-Step Guide to Wiring a 3 Phase DB Box

Learn about the wiring process for a 3 phase distribution board (DB) box, including the necessary steps and safety precautions. Understand how to connect the



Explore Power Distribution Box Types and Functions

To put it bluntly, the distribution box is the control and distribution center of electricity. Distribution boxes vary in shape and structure due to different



The Ultimate Guide to Distribution Box Types

Discover the key types of distribution boxes with NUOMAK's comprehensive guide. Learn about Main Distribution Boards (MDB), Consumer Units, Transfer

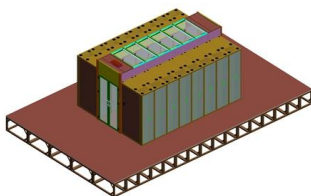



Understanding Distribution Boxes: A Comprehensive Guide

A distribution box is used to receive electrical power from a main supply and distribute it to multiple branch circuits in a safe and controlled way. It



Distribution Boxes: Types and Functions

Types and Functions of Different Distribution Boxes Main Lug Panel This type of distribution box is typically used downstream of a main breaker. The

Understanding Distribution Boxes: A Comprehensive Guide

The way a distribution box operates is simple and easy to understand. An electrical wire from the main power supply connects to the



Distribution Boxes Explained: Types, Functions, and

Learn about distribution boxes, their types, functions, and safety features to ensure efficient and secure electrical power distribution in any building.



Contact Us

For datasheets, pricing, or custom telecom energy solutions, please visit:
<https://koskolong.co.za>