

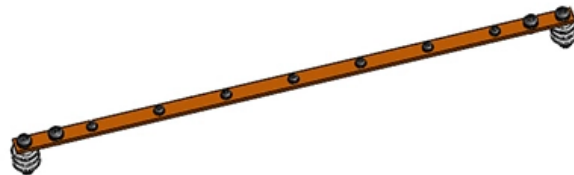

**Adam Tas Corridor Energy**

# **Distance between gas supply box and electrical distribution box**





## Overview

---

A minimum spacing of 25 mm must be maintained between your gas line and the electric circuit. These factors include the circuit type, cable strength, and the risk posed by these appliances. These guidelines provide you with information on the installation of gas mains, services, meters, and other parts of our gas networks. How close can an electrical socket be to a gas pipe?

Gas pipes should also be at least 150mm from electrical supply equipment such as electric metering equipment, service cut-outs, main isolation switches or consumer units. When arranging the gas supply for your home or apartment, you need to think through a huge number of things, in particular, the distance from the outlet to the gas pipe, regardless of when the electrical wiring was installed or reconstructed, before or after the development of the project.



## Distance between gas supply box and electrical distribution box

---

### Meter installation guidelines

There shall be a minimum distance of 3 feet of unobstructed working space, measured from the meter face, in front of all electric and natural gas meters. We



### Electrical Panel Clearance Distance FAQs

I have not found such a reference. There is not a standard electrical code requirement that gives the minimum clearance distance between an electrical panel and a plumbing fixture, but you can figure a

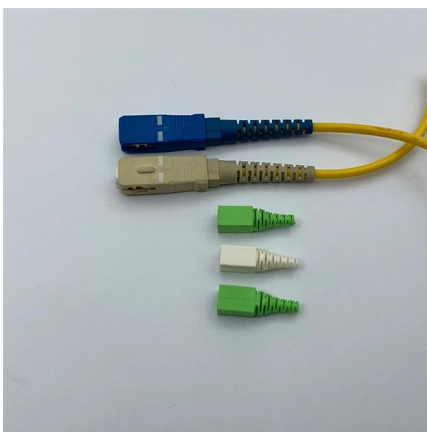

### Guidelines for Designers and Builders - Domestic Sites

A minimum separation of 150mm from the gas meter box to the ESB box, a minimum separation of 400mm from an electrical distribution board and 300mm from the gas service to any other services.

### Gas Meter Clearance Distance Q& A

Gas meter clearance distance questions & answers: Answers to common questions about the required distances between a gas meter and



building walls, decks, fences, and other building



## GTC Technical Guidelines

For low pressure installations the minimum distance from a gas pipe to an electricity cable inside a property should be 25mm, and 150mm from an electricity meter box or any switchgear.

## GAS METER INSTALLATION GUIDE

Gas Service Installations and Gas Meter Box Locations This section sets out ELS' standard requirements for the laying of gas services and the location of gas meter boxes. The route of the



## Gas meter in cupboard and electric outlet proximity

BS 6891:2005 Installation of low pressure gas pipework in domestic premises, clause 8.16.2 states that gas installation pipes must be spaced at least 150mm away from electricity meters, controls,



## Minimum Distance Between The Gas Meter And An

The distance requirements for gas piping are different from those of gas meters. According to BS 6891:2005, gas piping should be at least 150mm

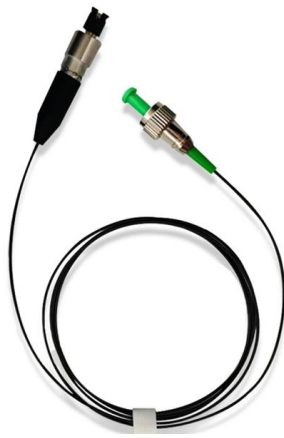

## Gas regs distance for electrics.

Gas service pipes must be at least 150mm from electricity meters, controls, electrical switches or sockets, distribution boards or consumer units and at least 25mm from electricity cables.

## Minimum Distances Electricity & Gas , DIYnot Forums

Where installation pipes are not separated by electrical insulating material, they shall be spaced as follows: a) at least 150 mm away from electricity meters and associated excess current



## Minimum Distance Between The Gas Meter And An

What is the minimum required distance between the gas meter and an electric socket? Read on to learn more in our latest article.



## Can we help you? Part 2

Q: What are the distances I need from a gas pipe to electrics? A: Gas pipework should be at least 25mm from electric switches, sockets, supply or distribution



## How Far Does A Gas Line Have To Be From Electrical?

A minimum spacing of 25 mm must be maintained between your gas line and the electric circuit. Keep in mind that the distance may be affected by a



## How close can an electrical socket be to a gas pipe?

Gas service pipes must be at least 150mm from electricity meters, controls, electrical switches or sockets, distribution boards or consumer units and at least 25mm from electricity cables.





## What Is the Electrical Code Distance From a Gas Line?

Both the National Electrical Code (NEC) and the National Fuel Gas Code (NFPA 54) generally require a minimum horizontal separation of 12 inches (one foot) between underground electrical service

## GTC Technical Guidelines

New unmetered supplies of <500W shall be taken directly from the LV distribution network or an extension of the LV distribution network in accordance. Where this cannot be achieved for practical



## Minimum Distances Electricity & Gas , DIYnot Forums

a) at least 150 mm away from electricity meters and associated excess current controls, electrical switches or sockets, distribution boards or consumer units; b) at least 25 mm away from

## Electrical/Gas Question

The concern for distances is between the gas outlet and the power outlet not the internal services running thru walls - and that distance is 300mm for a powerpoint / switch to a gas outlet i.e.





## Key Points Of Installation And Collocation Of Distribution Box In

The vertical distance between the bottom surface of the fixed distribution box and switch box and the ground shall be greater than 1.3m, less than 1.5m The vertical distance between the bottom of



## Distance from the gas pipe to the socket, electrical cable, electrical

When arranging the gas supply for your home or apartment, you need to think through a huge number of things, in particular, the distance from the outlet to the gas pipe, regardless of when the electrical

## Consumer unit too close to gas meter

Where installation pipes are not separated by electrical insulating material, they shall be spaced as follows: a) at least 150 mm away from electricity



## The Gas Safety (Installation and Use) Regulations 1998

The 1994 Regulations made provision in respect of the installation and use of gas fittings for the purpose of protecting the public from dangers arising from the distribution, supply or use of gas.



## Gas Meter Clearance Distance FAQs-2 Q& A on space

Gas meter clearance distance questions & answers: Answers to common questions about the required distances between a gas meter and building walls, decks, fences, and other building



## Gas pipe and main electricity cable distance

In a cupboard in the hall the electricity and gas enter the house. Have seen references to minimum distance between gas pipes and electrical cables needing to be 25mm. The gap between

## separation of pipework and gas meters from electrical

The gas installation and pipework in your premises is not fitted to the current standards as quoted in British Standards BS 6891: 2015 separation of





## Electrical Wire Clearance Distances

Electrical Wire Clearances from Ducts & Pipes  
What distance should be kept between electrical wires or boxes and nearby plumbing pipes or HVAC ducts? Some basic wire clearance distances are given in

### D. Minimum Clearance Requirements

D. Minimum Clearance Requirements Figure 2-19, "Electric and Gas Meter Set Separation Dimensions and Clearances," found below, Figure 2-20, "Gas Meter Set Clearance From Building Openings," on



## Contact Us

---

For datasheets, pricing, or custom telecom energy solutions, please visit:  
<https://koskolong.co.za>