



**Adam Tas Corridor Energy**

# **Is scaffolding required for cable tray installation**





## Is scaffolding required for cable tray installation

---



### **Method Statement for Cable Tray & Ladder Installation**

Our Method Statement for Cable Tray & Ladder Installation outlines the systematic process, safety measures, and equipment required for the efficient and secure

### **Best Practice Guide to Cable Ladder and Cable Tray Systems**

Cable ladders, cable trays and their supports should be strong enough to meet the load requirements of the cable management system including cables and any future cable additions and any other

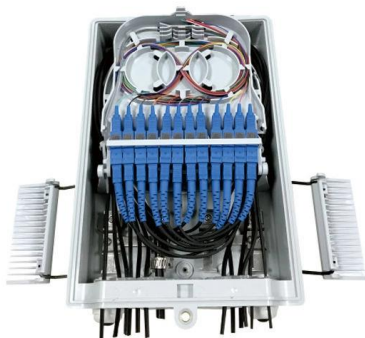
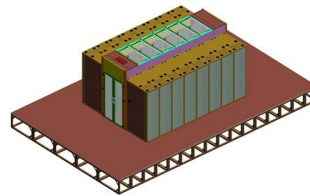

### **GRP Cable Tray & Cable Ladders , EAE Electric**

GRP Cable Ladder and GRP Cable Tray, particularly suitable for interior and exterior areas where resistance to corrosion is a requirement. GRP Cable Trays and

### **Method Statement installation of Cable Trays and Ladders**

This method statement covers the site installation of the cable tray & ladders and the



requirements of checks to be carried out.



## **A Guide to Installing and Supporting Electrical Cable Trays**

A professional guide to installing electrical cable tray systems per NEC Article 392. Covers support, securing cables, and fill calculations.

## **Cable Tray Installation Method Statement**

Ladders / Scaffoldings to be secured firmly over the working platform and inspected by competent personnel and tagging system (green/red) are implemented, prior

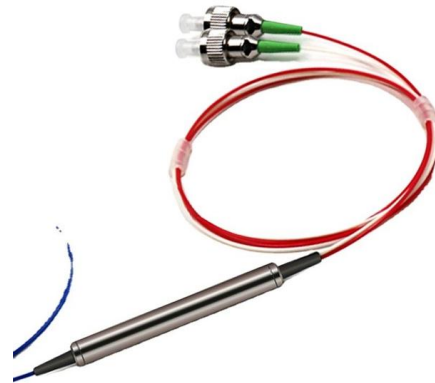

## **5 Steps to Learn How to Install Cable Trays**

Installing a cable tray system requires careful planning to ensure it can support the weight of the cables and adheres to electrical safety codes. Here





## Cable Tray Systems: Requirements and Best Practices

Cable tray systems offer a flexible and efficient solution for supporting large numbers of cables in modern electrical installations. When correctly designed and installed, they improve cable



## Beama Best Practice Guide , Installation Of The System , Cable

2.2 Structural characteristics When considering the installation of the cable supports system it is imperative to avoid the cutting or drilling of structural building members without the approval of the

## Safely Installing, Maintaining and Inspecting Cable Trays

Review the proper methods for safely installing, maintaining and inspecting electrical cable trays; Provide information regarding the hazards of overloaded cable trays;



## Cable Tray Installation Method Statement , PDF

The document provides guidelines for installing cable trays at project sites in 3 steps: (1) receiving and storing material, (2) installation procedure, and (3) precautions.

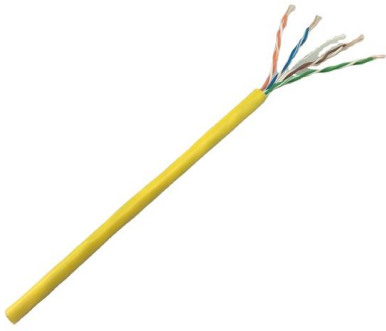

## Cable Tray Installation Method Statement , PDF

This document outlines the method statement for the installation of cable trays, including the scope of work, management structure, and detailed installation



- ✓ TELECOM CABINET
- ✓ BRAND NEW ORIGINAL
- ✓ HIGH-EFFICIENCY



## Cable Tray Installation Method Statement , PDF

The method statement requires a survey of the entire cable tray route to identify any existing hindrance due to other system work, such as piping or air ventilation.

## Cable Tray Trunking & Ladder Installation Method for

Working Platforms: Scaffolding as required within the specific work area. Cable Tray, trunking and ladder will be properly supported and stacked in a flat surface. Tray,

### Pre-Terminated Patch Panel

- Standard 19" width
- Max 144 fibers in 1U
- MPO/Fusion Dual-Purpose



Removable Cable Management Tray



Transparent Front Cover



High-Quality Matte Coated Steel

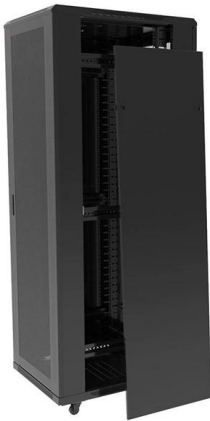

## Important design considerations for cable ladder and

Ladder and tray systems differ slightly from conduit and trunking systems in that they are not enclosures, and they do not provide mechanical

## Installation of Cable Tray, Trunking And Accessories

2. Purpose This method statement for the Installation of Cable Tray, Trunking, and Accessories shows and explains the procedure must be followed to install the cable tray and



## Master Cable Tray Installation: A Professional Step-by

Learn how to install cable trays for large-scale projects with our professional, step-by-step guide covering industry standards, safety protocols,



## Cable Tray Installation

Whether you're building a commercial setup or upgrading an industrial plant, proper cable tray installation ensures neat wiring, safe access, and easy maintenance. But before you lay the first tray

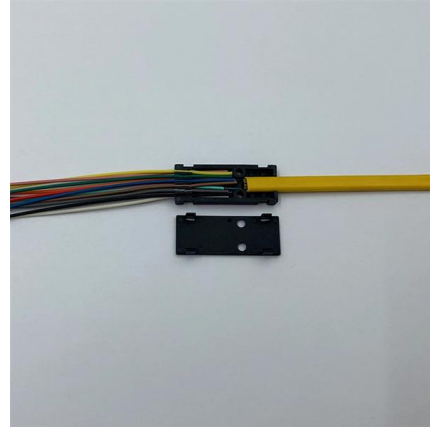

## Mastering Cable Tray Installation , Step-by-Step Guide for a Seamless

Conclusion Mastering cable tray installation is crucial for creating a safe, organised, and efficient cable management system. By following this step-by-step guide, you can ensure a seamless



## Cable Tray Installation Method Statement , PDF

The document provides guidelines for installing cable trays at project sites in 3 steps: (1) receiving and storing material, (2) installation procedure, and (3) precautions.



## Best Practice Guide to Cable Ladder and Cable Tray Systems

Introduction This publication is intended as a practical guide for the proper and safe\* installation of cable ladder systems, cable tray systems, channel support systems and associated supports.





## Cable Tray Installation

Learn everything about cable tray installation with our complete guide. Discover types, steps, and safety tips for efficient electrical cable management.



## What we commonly call power strips are frequently used around BNL

Page 1 of 1 Figure 2 - Improper Cable Tray Installation All cables and conductors approved for use in cable trays are required to be insulated.

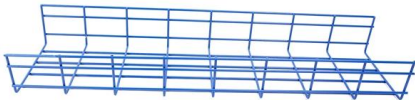

## Cable Tray Technical Guide A practical guide to product selection and

In designing supports for a cable tray system, consideration should be given to the loads associated with future cable additions and any additional loading that may be applied to the cable tray system (e.g.,



## Cable Tray Spacing Standards for Installation and Safety

Proper installation can significantly reduce electromagnetic interference, prevent fire hazards, and improve overall efficiency. This article

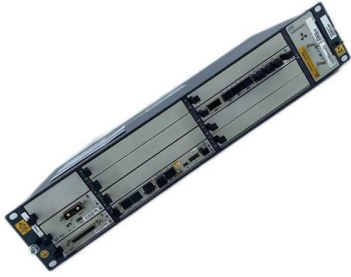

## Best practice guide to cable ladder and cable tray

Cable ladder and cable tray systems The following recommendations are intended to be a practical guide to ensure the safe and proper installation of



## CABLE TRAYS GENERAL INFORMATION AND

Using cable trays as walkways can cause personal injury and also damage cable tray and installed cables. Performances of cable tray systems are dependent on

## Cable Tray Systems: Requirements and Best Practices

This article explains the main requirements and good practices for cable tray systems, including tray types, materials, loading, supports, bonding, cable selection, and installation details.





## Contact Us

---

For datasheets, pricing, or custom telecom energy solutions, please visit:  
<https://koskolong.co.za>