

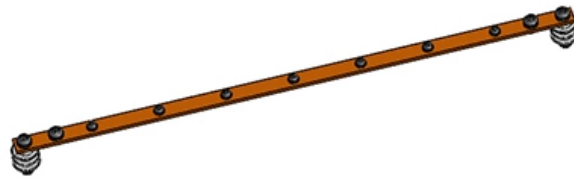

Adam Tas Corridor Energy

Types and Specifications of Optical Cable Splice Boxes





Types and Specifications of Optical Cable Splice Boxes



What are the classifications of optical cable splice boxes

Optical cable splice boxes are usually suitable for indoor or non-open outdoor use, and are not suitable for outdoor use. If they are to be used, protective measures should be taken.

Fusion Splicers , Telecommunication Systems Business

Telecommunication uses Fusion splicer enable splicing of Fiber Optic Cable with low loss and high reliability. For fusion splicer, we offer two types: Core alignment



Fiber Splice Boxes , Amphenol Network Solutions

Fiber splice boxes from Amphenol Network Solutions are designed for splice-only applications. They are suited for optical cable splice collection points for DAS,

FOSC-OPGW , CommScope

2 OPGW cables 2 ADSS or conventional buried fiber optic cables Cable seals are manufactured from heatshrinkable material Internal storage



utilizes FOSC splice trays which are hinged for access to

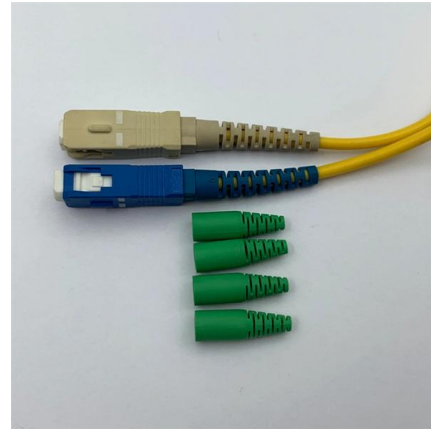

4 in 4 Out Inline Fiber Splice Enclosure, 192 Cores Splice

Designed like a flat case, the 192 core inline fiber splice closure integrates distribution, splicing, jointing, and storage functions for outdoor optical cables.

Fiber Splice Closures

Explore reliable optical fiber splice closures for network deployment. Our closures prioritize reliability, installability, and flexibility

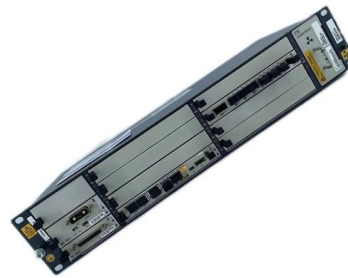

Fiber Splice Closures

Explore reliable optical fiber splice closures for network deployment. Our closures prioritize reliability, installability, and flexibility.



Fiber Joint Box VS Fibre Optic Enclosures VS Fiber Splicing Box

Fiber Joint Box, Fibre Optic Enclosures, and Fiber Splicing Box each serve distinct but complementary roles in modern fiber optic networks. Understanding their differences is essential for



Optical Distribution Frames (ODF)

Explore optical distribution frames (ODF) with efficient distributed chassis solutions at CommScope

FO Splice Boxes in Glass-Fiber Reinforced Polyester

The splice trays are according to DIN 47662 and Telecom standards, each tray can hold up to 12 fusion-type splices and is equipped with appropriate splice protection holders and FO strain reliefs.



288F Vertical Fibre Optic Cable Joint Box/ Dome Type Optical Fibre

288F Vertical Fibre Optic Cable Joint Box/ Dome Type Optical Fibre Splice Closure, for splicing up to 7 cables, maximum cable size: up to diameter 38mm. Maximum capacity :Up to 288Cores.



HJ Outdoor Fiber Optic Terminal Box Metal Wall Mount Waterproof

The optical cable terminal box series serves as an auxiliary device for terminal distribution within optical fiber transmission networks. It is suitable for the direct and branch splicing of indoor or outdoor



FOSC-MSC , CommScope

FOSC® MSC Fiber Optic Modular Splice Closure
Single ended o-ring sealed dome closure for high capacity splicing in a versatile and modular build
Leverages proven FOSC (TM) fiber management

In-line Fiber Splice Closure With 4 Cable Port, 96 Splices

The horizontal fiber optic splice closure comes with 2 cable ports on both sides, supporting max 96 core splices. It enables internet service provider to build

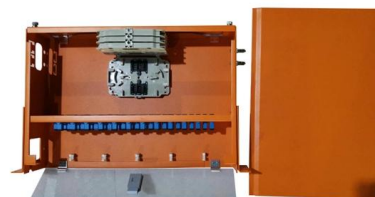



Fiber Optic Splice Closure Guide , Structure, Types

Comprehensive guide to fiber optic splice closures covering structure, fiber management systems, sealing design, mid-span access, UV-resistant

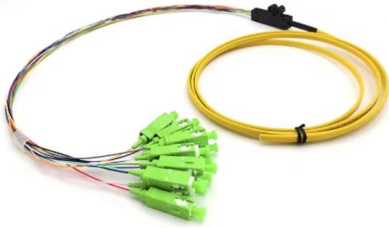

Fiber Optic Splice Enclosure Types and Selection Guide

A typical fiber optic splice enclosure consists of several key components that work together to protect and organize the fiber splices. Standard enclosures contain: 1)



FTTH Terminal Boxs Types Prices & Technical

FTTH Termination Box available for the distribution and terminal connection for various kinds of optical fiber system, Some are used for indoor cabling and others

Fiber Optic Splice Boxes: Selection Criteria, and

This history is invaluable for streamlining future troubleshooting and network planning. Conclusion Fiber Optic Splice Boxes are fundamental to the resilience



SB01 Splice Enclosure and Accessories

AFL's SB01 splice enclosure box provides protection from all types of elements. From weather to bullets, the iron and steel construction requires no additional



48 Core Fiber Optic Splice Joint Closure Dome Types

48 Core Fiber Optic Splice Joint Closure Dome Types F101H are used to distribute, splice, and store the outdoor optical cables which enter and exit from



From standard 1U to 8U sizes to fully customized Non-standard enclosures.

288 Core Vertical Fiber Splice Closure With Splitter Slot

Shop Premium Fiber Optic Products Discover a wide range of high-quality Fiber Optic Products, including termination boxes, splice enclosures, patch panels, and





What are the classifications of optical cable splice boxes

The optical cable splice box is suitable for the straight-through and branch connection of various structural optical cables such as overhead, pipeline, direct burial and other laying methods.



SB01 Splice Enclosure and Accessories

Furnished with four plugged cable ports (2 aluminum and 2 plastic) for either All-Dielectric Self-Supporting (ADSS) or Optical Ground Wire (OPGW) cables, the

What is a Fiber Optic Pigtail, and What Is It Used For?

A fiber optic pigtail is a type of fiber optic cable with only one end that has a factory-terminated connector and the other end exposed as bare fiber. A



Hubs, Closures, Terminals & Boxes

Hubs, Closures, Terminals & Boxes ensure superior protection, reliability and scalability for your outdoor networks.



FIST-MSD , CommScope

FIST fiber management Transient-free, modular, flexible fiber management FIST single-circuit and single-element splice trays Up to 1248 splices with standard domes: expandable splice capacity with

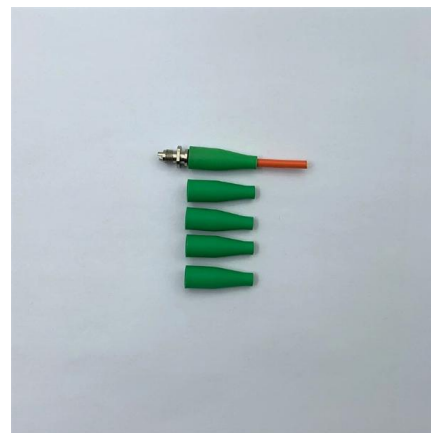

Fiber Optic Splice Boxes: Selection Criteria, and

What factors should be considered when selecting a fiber optic splice box? Consider the type of fibers, environmental conditions (indoor vs. outdoor), capacity

Horizontal 12 24 Core Fiber Optic Splice Closures

Fiber optic splice closures are one of the most important types of equipment for user access points, and junction box fiber optic splice cases are used to protect and





4 Cores Fiber Optic Distribution Box 4 Outlet 1 Entry Box For Drop Cable

Product Summary Fiber Optic Cable Termination Box 4 Cores 1 Entry Port 4 Outlet Ports For Drop Cable Description: Fiber Terminal boxes designed to meet the market demand are divided into direct

Introduction of optical cable splicing box enclosure

The optical cable connection part, that is, the optical cable joint, is the part that protects the connection between two or more optical cables by the



Contact Us

For datasheets, pricing, or custom telecom energy solutions, please visit:
<https://koskolong.co.za>